

APPLICATION INSTRUCTIONS REUSABLE SIGNS "ANGLES MORTS"

The slightly adhesive silicone film can only be applied to clean, flat and smooth or lacquered surfaces. The signs can be reused several times

HOW TO APPLY THE SELF-CLING SIGNS:

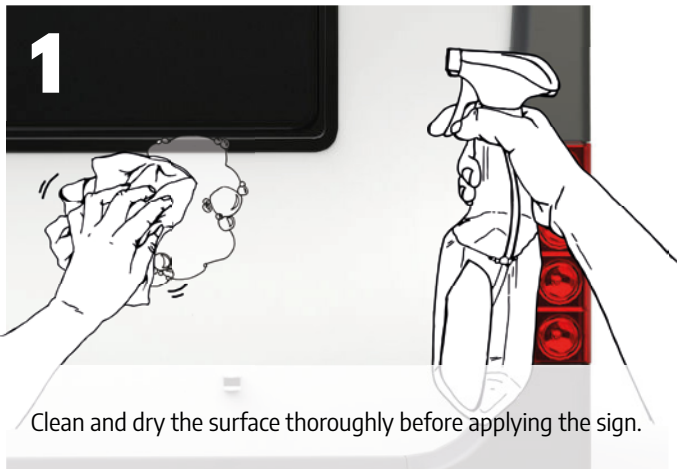

Remove the sign before washing your vehicle. Do not use the automatic carwash or highpressure washers with the sign in place.

There is always the risk of losing the reusable sign due to wind, rain or dirt. Therefore it is important to use the sign only when needed and to avoid any trips with the signs attached when they actually are not required (e. g. on motorways).